



## The Charles

- 2757 sq. ft., 4 bedrooms, 2 1/2 baths, 3 car garage
- Custom tile shower in Master bath
- Detailed trim work
- Stone face fireplace
- Covered Patio
- 5 star efficient home
- Upgraded cabinets with granite tops & backsplash



MAIN FLOOR AREA.....1644.0 SQ. FT.  
 SECOND FLOOR AREA.....1393.1 SQ. FT.  
 TOTAL AREA.....2756.1 SQ. FT.

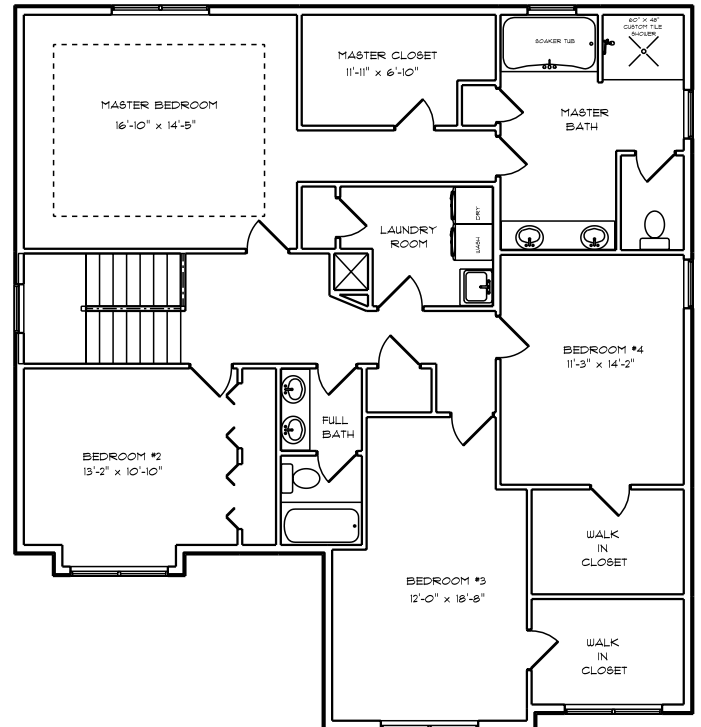

Eenigenburg Builders  
 141B Matteson Street  
 Dyer, IN 46311  
 Phone: 219.322.0906  
 Fax: 219.322.8110

[www.ebihomes.com](http://www.ebihomes.com)